

## Covington's House of Baggers & Drag Specialties Foot Controls & Peg Mounts Installation

Story by **Jason Mook** – Photos by **Jesse B. Nelson**

**P**roject 98 is nearing completion of the mock up prior to paint and our focus is on rider comfort combined with improved style. Many riders find that the stock floorboards are too small with limited space to change foot positions. Covington's House of Baggers produces an extensive line of parts and accessories for your Bagger, including floorboards that are larger than stock. The floorboards give you more room for your boots and they are able to be mounted forward or back for a more customized foot location. Complementing the floorboards are shift pegs, passenger pegs, and brake pedal, all in the finned black and contrast finish. Drag Specialties offers a variety of passenger peg mounts that accept the standard peg clevis and mount with stock hardware. For the complete line of parts available from Drag Specialties, log on to [www.DragSpecialties.com](http://www.DragSpecialties.com). To see all the Bagger products available from Covington's House of Baggers, visit [www.CovingtonsCustoms.com](http://www.CovingtonsCustoms.com).

**Difficulty Level:** 1/5

**Estimated Time to Complete:** 1.5 hours



**PRODUCT**

Covington's Finned Floorboards, Passenger Pegs, Shifter Pegs, and Brake Pedal, in black. Drag Specialties Passenger Peg Mounts in chrome.



**BEFORE #1**

Project 98 with stock floorboards and pegs.

### Tools & Supplies Needed

- Allen Wrenches
- 3/8" Ratchet
- SAE Wrench Set
- Locking Pliers
- Torque Wrench
- Removable (blue) Thread Locker
- Spring Washer (2) OEM #50912-72



**BEFORE #2**



**1**

Apply blue thread locker to the included hardware.

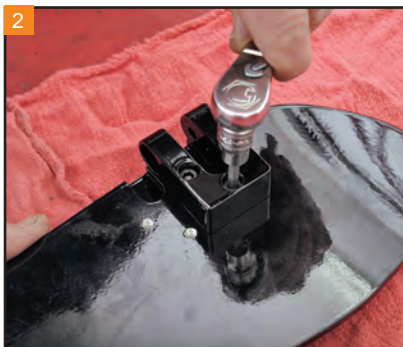

**2**

Choose the position of the floorboard mounts. Use a 3/16" Allen to tighten the bolts, three per mount.



**3**

Final torque the bolts to 90-120 inch/lbs.

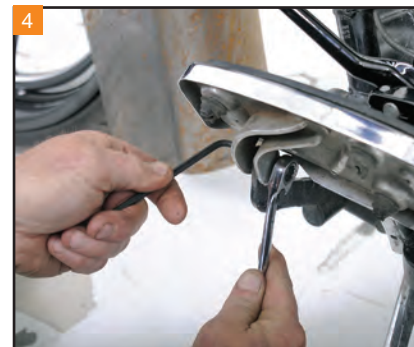

**4**

Loosen the floorboard hardware with a 3/16" Allen and 7/16" wrench.

# COVINGTON'S HOUSE OF BAGGERS & DRAG SPECIALTIES

## Foot Controls & Peg Mounts Installation



Remove the floorboards from the mounting brackets.



Position the Covington's Floorboards on the mounting brackets.



Use the stock hardware with the Finned Floorboards.



Use locking pliers to remove the stock rubber shift peg from the shift arm.



Apply blue thread locker to the included hardware for the Covington's shift pegs.



Use a long 1/4" Allen to tighten the bolt holding the shift peg to the shift arm.



Repeat the process for the second shift peg.



Remove the bolt holding the stock passenger floorboard bracket with a 5/16" Allen.



The passenger floorboard and mounting bracket can be removed as an assembly.



Apply blue thread locker to the stock bolt. Install the Drag Specialties passenger peg mount in the stock location of the floorboard bracket.



Install the Covington's Passenger Peg with spring washer into the peg mount.

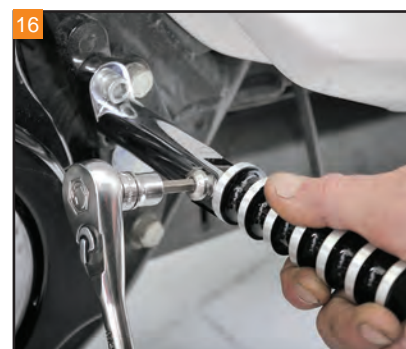

Apply blue thread locker to the bolt included with the passenger peg mount. Tighten the bolt with a 7/32" Allen wrench.



17 Loosen the right side floorboard hardware with a 3/16" Allen and 7/16" wrench.



18 Remove the floorboard from the mounting brackets.



19 In order to match the Covington's Fined Black Brake Pedal, the stock chrome brake arm is going to be replaced by a black powder coated one.



20 Slide the new black brake arm over the pivot shaft, ensuring the arm engages the actuator of the master cylinder. Install the pivot and retaining pins with washer.



21 Use a 5/8" wrench to tighten the nylock nut onto the end of the pivot shaft, with washer.



22 Position the right side Fined Floorboard over the mounting brackets.



23 Install the floorboard using the stock hardware.



24 Place the Covington's Fined Brake Pedal over pedestal of the brake arm.



25 Apply blue thread locker to the included hardware for the brake pedal. Tighten with a 1/4" Allen wrench.



26 Remove the bolt holding the right side passenger floorboard mount to the frame with a 5/16" Allen wrench.



27 Remove the passenger floorboard and mounting bracket as an assembly.



28 Install the Drag Specialties Passenger Peg Mount using the stock hardware. Use blue thread locker on the bolt.

# COVINGTON'S HOUSE OF BAGGERS & DRAG SPECIALTIES

## Foot Controls & Peg Mounts Installation



Position the Covington's Passenger Peg with spring washer in the clevis of the passenger peg mount.



Apply blue thread locker to the included bolt. Install the bolt and tighten with a 7/32" Allen wrench.



### COVINGTON'S HOUSE OF BAGGERS

*Finned Floorboards, Black (Pair).*

(Part # C1335-B)

*Finned Pegs, Black (Pair).*

(Part # C1242-B)

*Finned Brake Pedal, Black.*

(Part # C1042-B)

*Finned Peg, Shifter, Black (2 required).*

(Part # C1241-B)

580.256.2939

[www.CovingtonsCustoms.com](http://www.CovingtonsCustoms.com)

### DRAG SPECIALTIES

*Passenger Footpeg Mounts, Chrome.*

(Part # 1620-1056)

See Your Local Dealer

[www.DragSpecialties.com](http://www.DragSpecialties.com)

### BLACK HILLS CYCLES

- Work Performed By -

605.717.5009

[www.BlackHillsCycles.com](http://www.BlackHillsCycles.com)

Project 98 with Drag Specialties Peg Mounts and Covington's Finned Floorboards, Passenger Pegs, Shift Pegs, and Brake Pedal installed.